

IRONBARK RIDGE - STAGE 2B

LOT 217

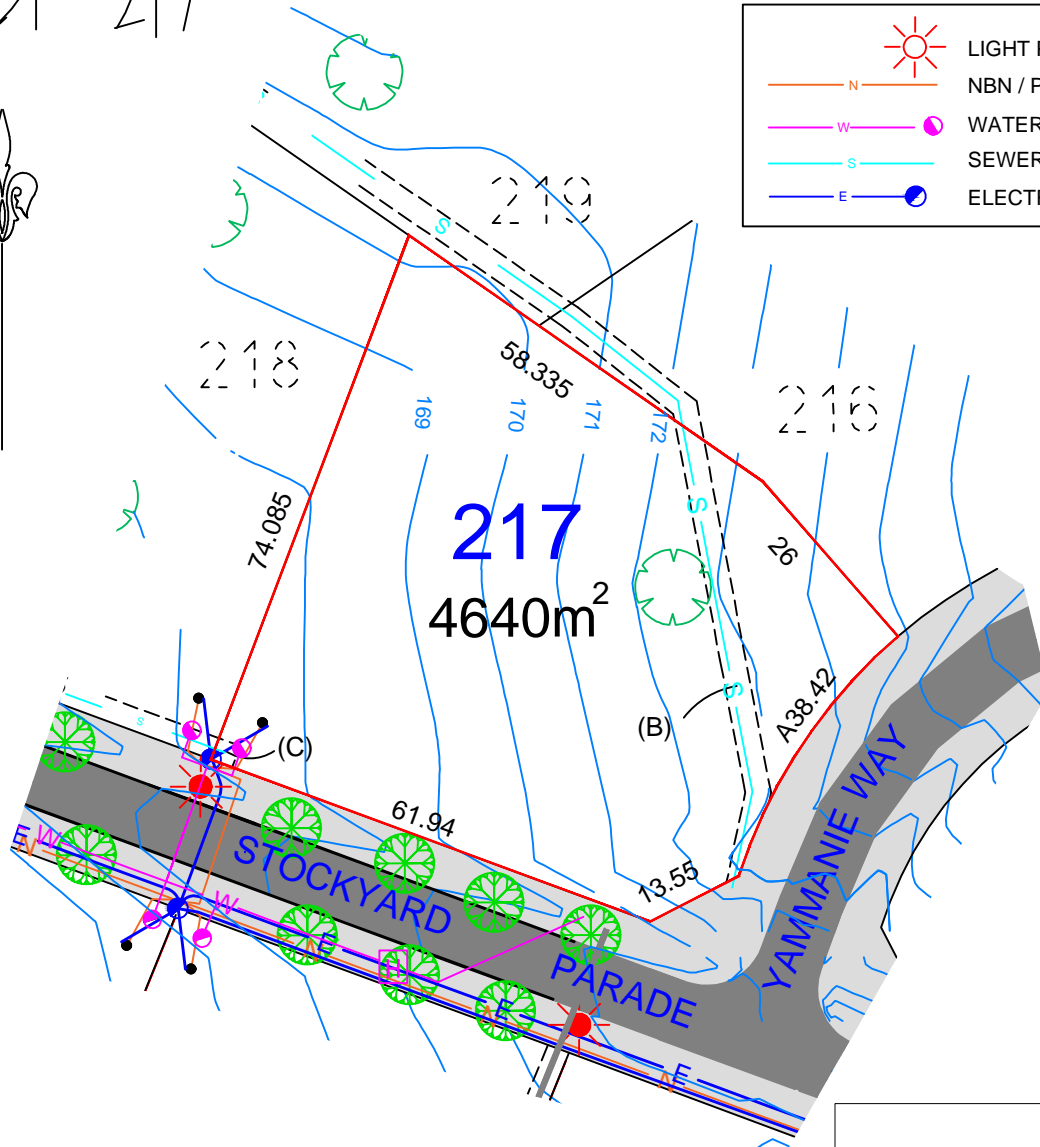
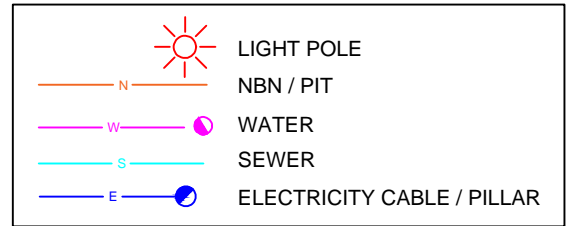
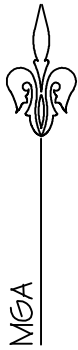

(B) EASEMENT TO DRAIN SEWAGE 3 WIDE AND 5 VARIABLE (DP1165467)

(C) EASEMENT TO DRAINAGE SEWAGE 3 WIDE AND VARIABLE WIDTH

DISCLAIMER/NOTES:

1. Contours are based on finished design levels and are subject to construction and Council certification and therefore should not be considered as final or as-built.
2. Location of utility services including but not limited to power, water, sewer, communications and gas are subject to construction and Supply Authority certification and therefore should not be considered as final or as-built.
3. Survey information such as boundary dimensions and areas, easements etc are subject to final survey. Purchasers should refer to the Deposited Plan and 88B Instrument contained in the Contract for Sale of Land for further detailed information.
4. Bushfire and Geotechnical classification are provided for convenience. Purchasers should refer to referenced detail specialists reports.
5. This Preliminary Site Analysis Plan has been collated from various sources of design information and is provided for convenience to assist Purchasers in obtaining quotations/tenders for dwelling construction.
6. This document does not form part of the Contract of Sale of the Land.

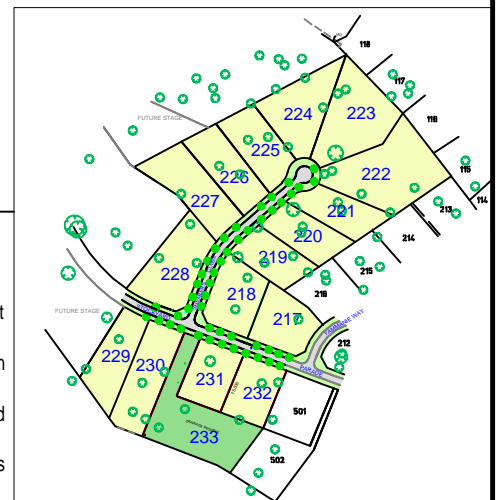

STAGE 2B

MM HYNDES BAILEY & Co.
 REGISTERED SURVEYORS - TOWN PLANNING - CIVIL DESIGN
Surveying the Hunter since 1920



IRONBARK RIDGE - STAGE 2B

LOT 218

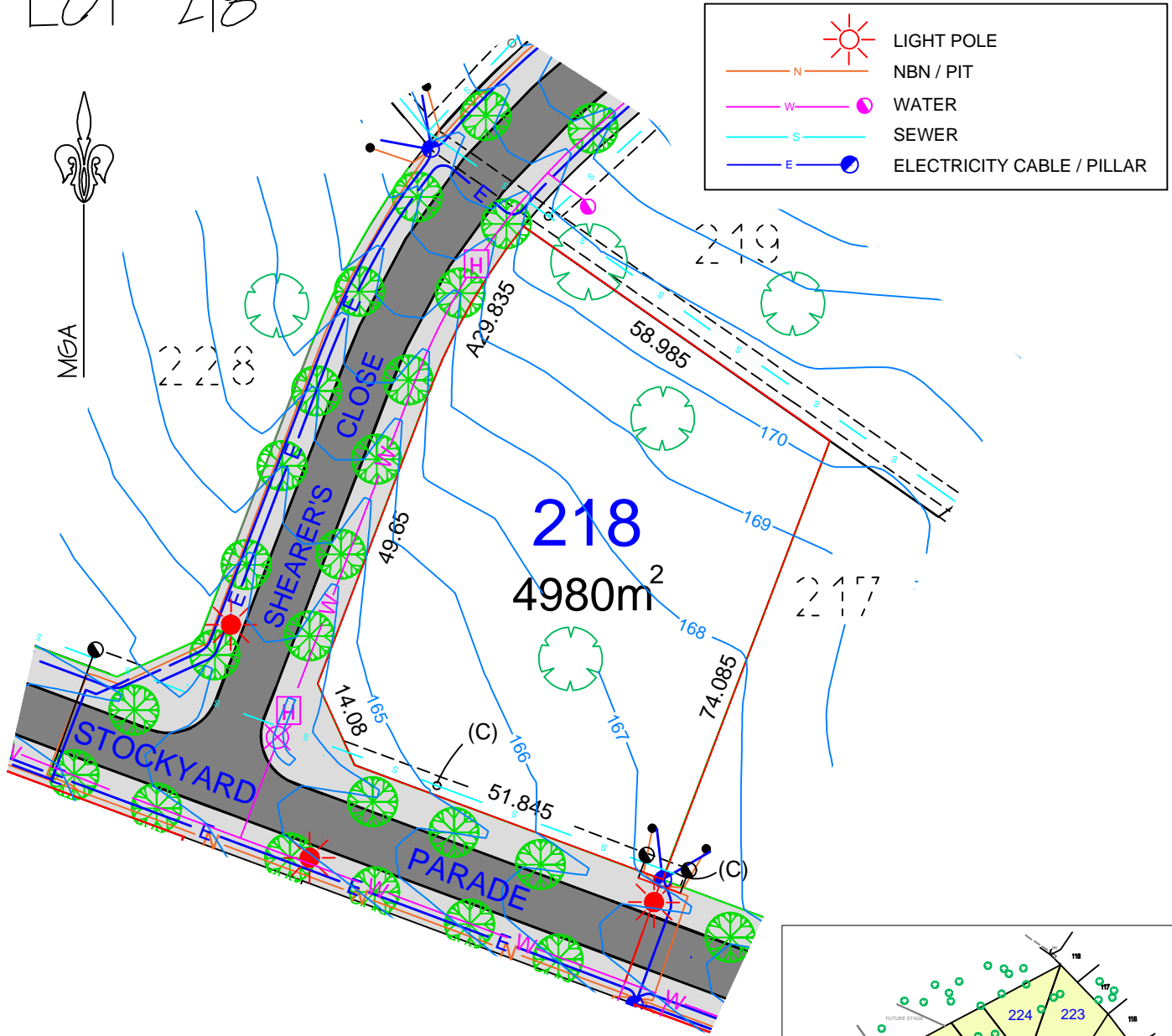

	LIGHT POLE
	NBN / PIT
	WATER
	SEWER
	ELECTRICITY CABLE / PILLAR

(C) EASEMENT TO DRAINAGE SEWAGE 3 WIDE AND VARIABLE WIDTH

DISCLAIMER/NOTES:

1. Contours are based on finished design levels and are subject to construction and Council certification and therefore should not be considered as final or as-built.
2. Location of utility services including but not limited to power, water, sewer, communications and gas are subject to construction and Supply Authority certification and therefore should not be considered as final or as-built.
3. Survey information such as boundary dimensions and areas, easements etc are subject to final survey. Purchasers should refer to the Deposited Plan and 88B Instrument contained in the Contract for Sale of Land for further detailed information.
4. Bushfire and Geotechnical classification are provided for convenience. Purchasers should refer to referenced detail specialists reports.
5. This Preliminary Site Analysis Plan has been collated from various sources of design information and is provided for convenience to assist Purchasers in obtaining quotations/tenders for dwelling construction.
6. This document does not form part of the Contract of Sale of the Land.

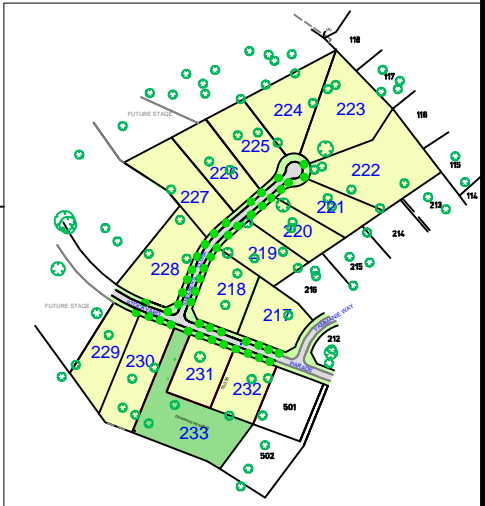

STAGE 2B

MM HYNDES BAILEY & Co.
 REGISTERED SURVEYORS - TOWN PLANNING - CIVIL DESIGN
Surveying the Hunter since 1920



IRONBARK RIDGE – STAGE 2B

LOT 219

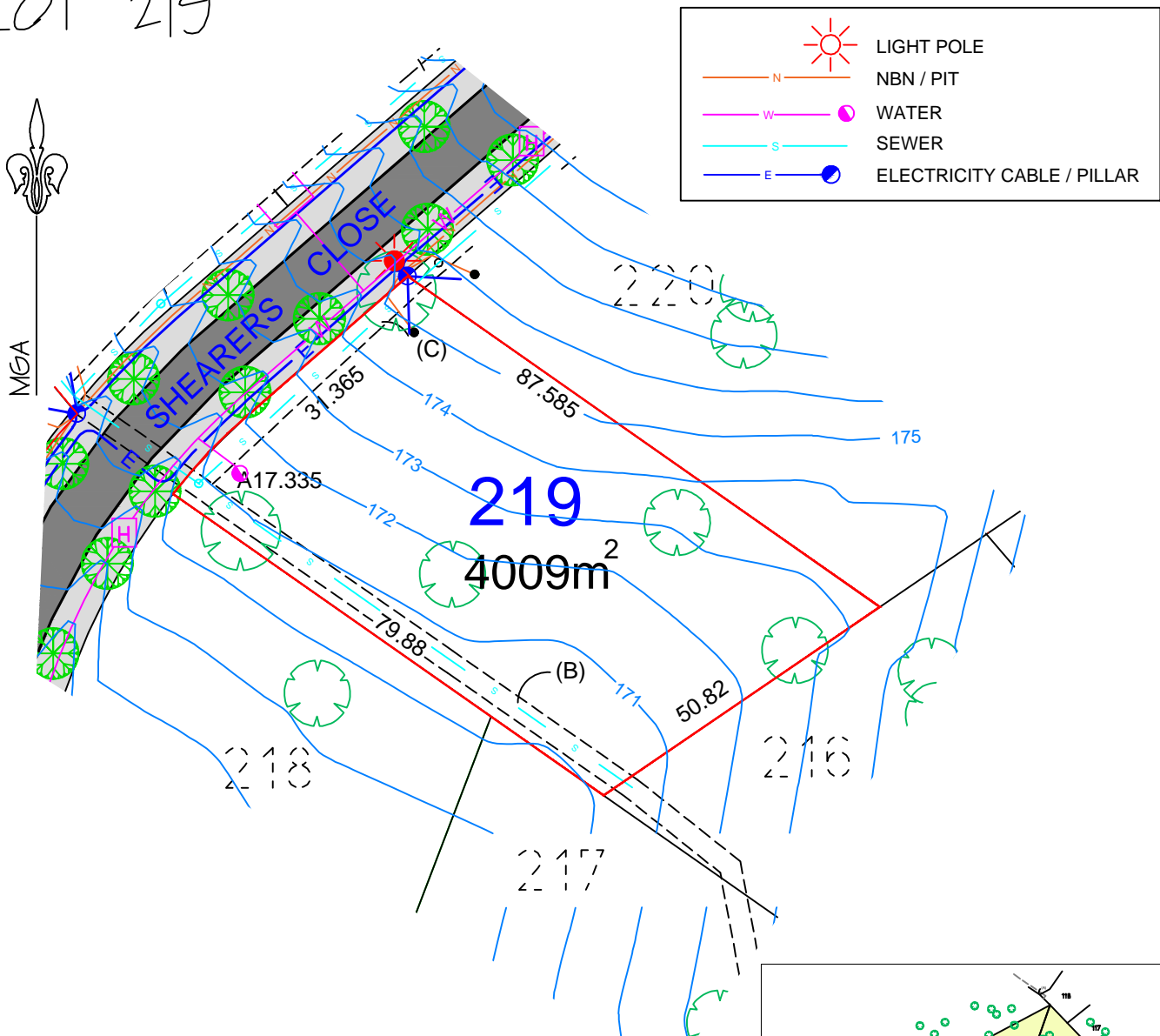

(B) EASEMENT TO DRAIN SEWAGE 3 WIDE AND 5 VARIABLE (DP1165467)
 (C) EASEMENT TO DRAINAGE SEWAGE 3 WIDE AND VARIABLE WIDTH

DISCLAIMER/NOTES:

1. Contours are based on finished design levels and are subject to construction and Council certification and therefore should not be considered as final or as-built.
2. Location of utility services including but not limited to power, water, sewer, communications and gas are subject to construction and Supply Authority certification and therefore should not be considered as final or as-built.
3. Survey information such as boundary dimensions and areas, easements etc are subject to final survey. Purchasers should refer to the Deposited Plan and 88B Instrument contained in the Contract for Sale of Land for further detailed information.
4. Bushfire and Geotechnical classification are provided for convenience. Purchasers should refer to referenced detail specialists reports.
5. This Preliminary Site Analysis Plan has been collated from various sources of design information and is provided for convenience to assist Purchasers in obtaining quotations/tenders for dwelling construction.
6. This document does not form part of the Contract of Sale of the Land.

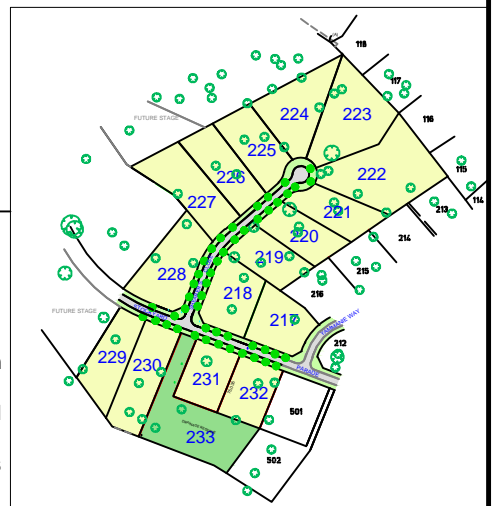

STAGE 2B

MM HYNDES BAILEY & Co.
 REGISTERED SURVEYORS - TOWN PLANNING - CIVIL DESIGN
Surveying the Hunter since 1920



IRONBARK RIDGE - STAGE 2B

LOT 220

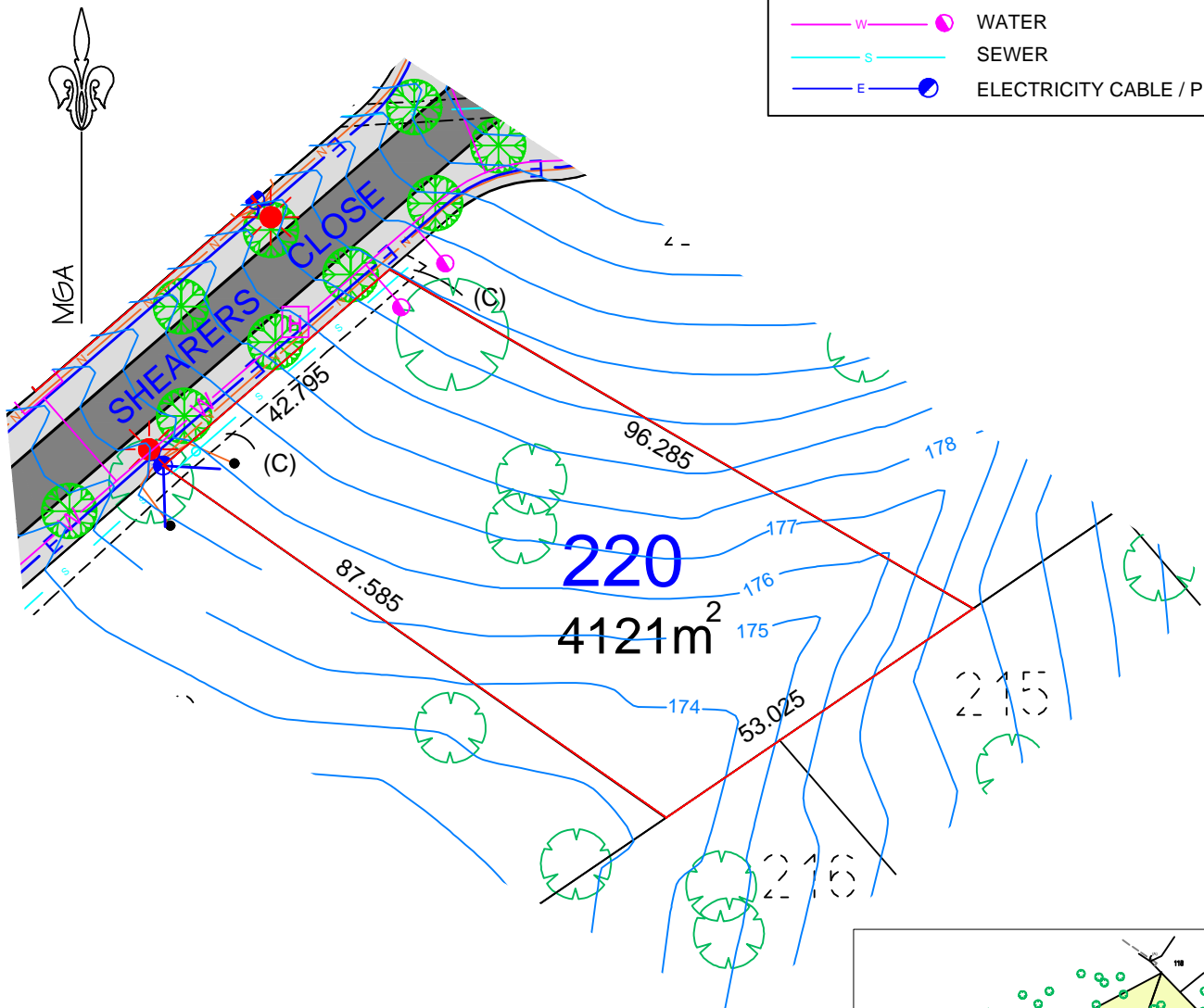
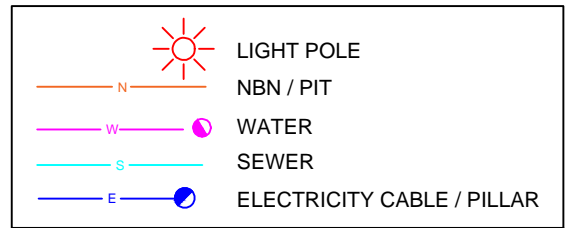

(C) EASEMENT TO DRAINAGE SEWAGE 3 WIDE AND VARIABLE WIDTH

DISCLAIMER/NOTES:

1. Contours are based on finished design levels and are subject to construction and Council certification and therefore should not be considered as final or as-built.
2. Location of utility services including but not limited to power, water, sewer, communications and gas are subject to construction and Supply Authority certification and therefore should not be considered as final or as-built.
3. Survey information such as boundary dimensions and areas, easements etc are subject to final survey. Purchasers should refer to the Deposited Plan and 88B Instrument contained in the Contract for Sale of Land for further detailed information.
4. Bushfire and Geotechnical classification are provided for convenience. Purchasers should refer to referenced detail specialists reports.
5. This Preliminary Site Analysis Plan has been collated from various sources of design information and is provided for convenience to assist Purchasers in obtaining quotations/tenders for dwelling construction.
6. This document does not form part of the Contract of Sale of the Land.

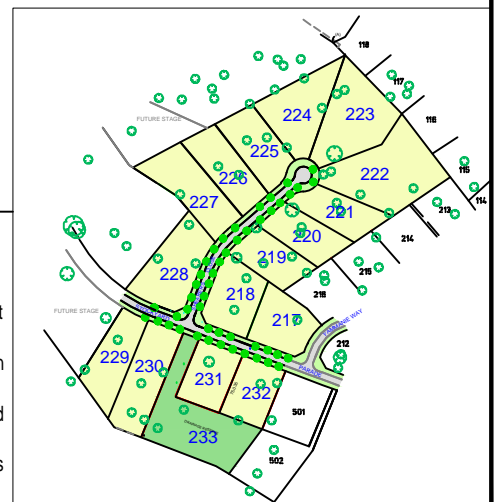

STAGE 2B

MM HYNDES BAILEY & Co.
 REGISTERED SURVEYORS - TOWN PLANNING - CIVIL DESIGN
Surveying the Hunter since 1920



IRONBARK RIDGE - STAGE 2B

LOT 221

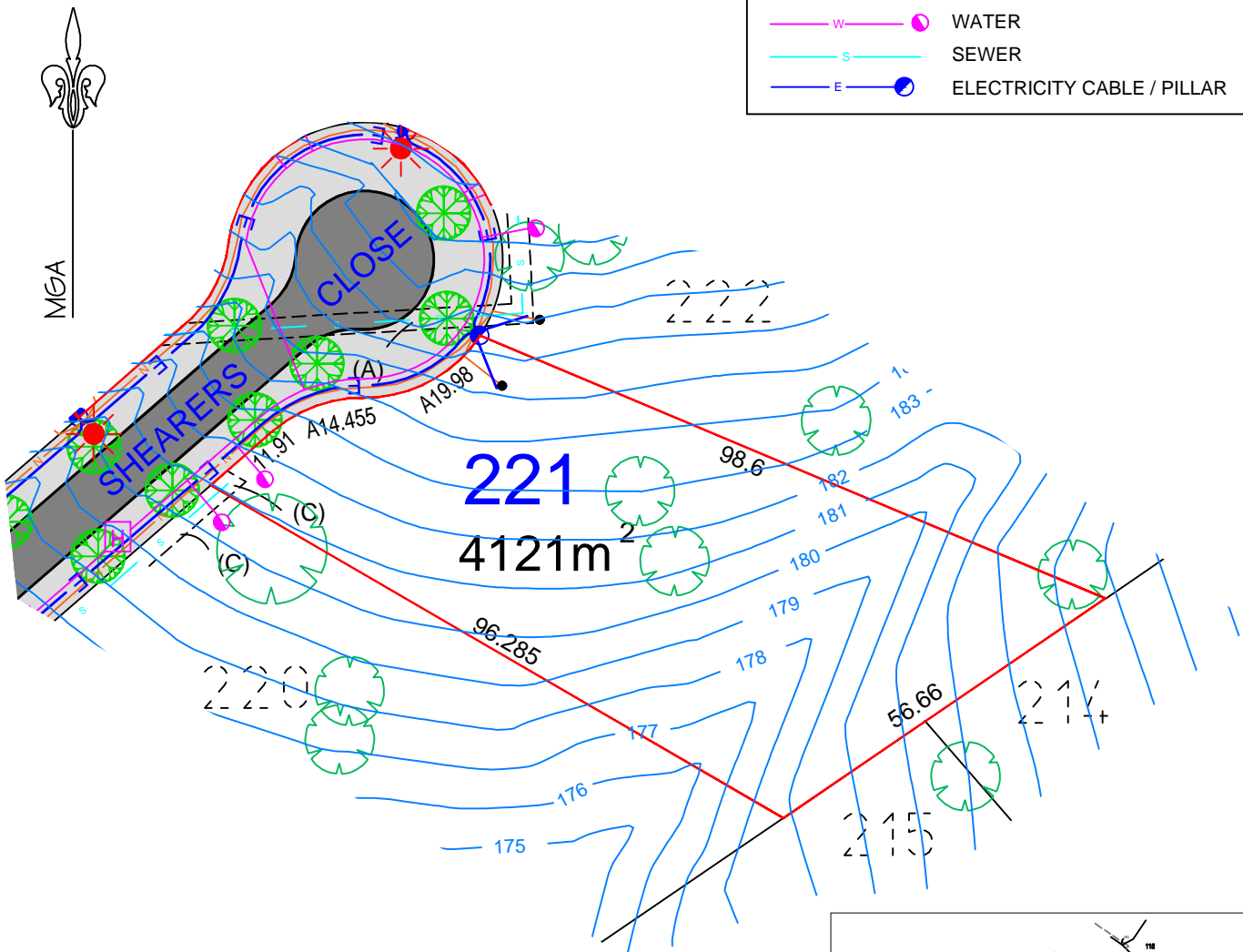
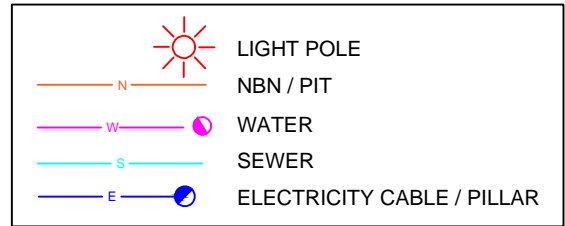

(C) EASEMENT TO DRAIN SEWAGE 3 WIDE AND VARIABLE WIDTH

DISCLAIMER/NOTES:

1. Contours are based on finished design levels and are subject to construction and Council certification and therefore should not be considered as final or as-built.
2. Location of utility services including but not limited to power, water, sewer, communications and gas are subject to construction and Supply Authority certification and therefore should not be considered as final or as-built.
3. Survey information such as boundary dimensions and areas, easements etc are subject to final survey. Purchasers should refer to the Deposited Plan and 88B Instrument contained in the Contract for Sale of Land for further detailed information.
4. Bushfire and Geotechnical classification are provided for convenience. Purchasers should refer to referenced detail specialists reports.
5. This Preliminary Site Analysis Plan has been collated from various sources of design information and is provided for convenience to assist Purchasers in obtaining quotations/tenders for dwelling construction.
6. This document does not form part of the Contract of Sale of the Land.

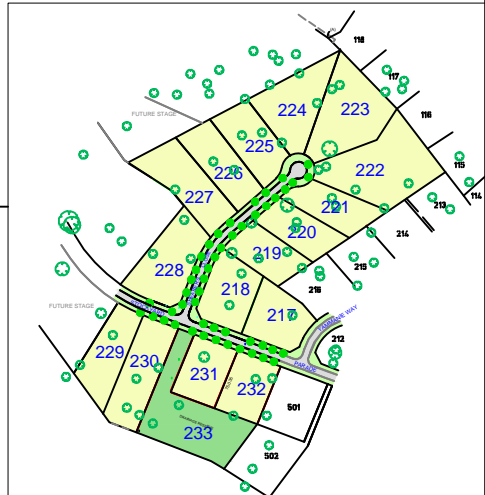

STAGE 2B

MM HYNDES BAILEY & Co.
 REGISTERED SURVEYORS - TOWN PLANNING - CIVIL DESIGN
Surveying the Hunter since 1920



IRONBARK RIDGE - STAGE 2B

LOT 222

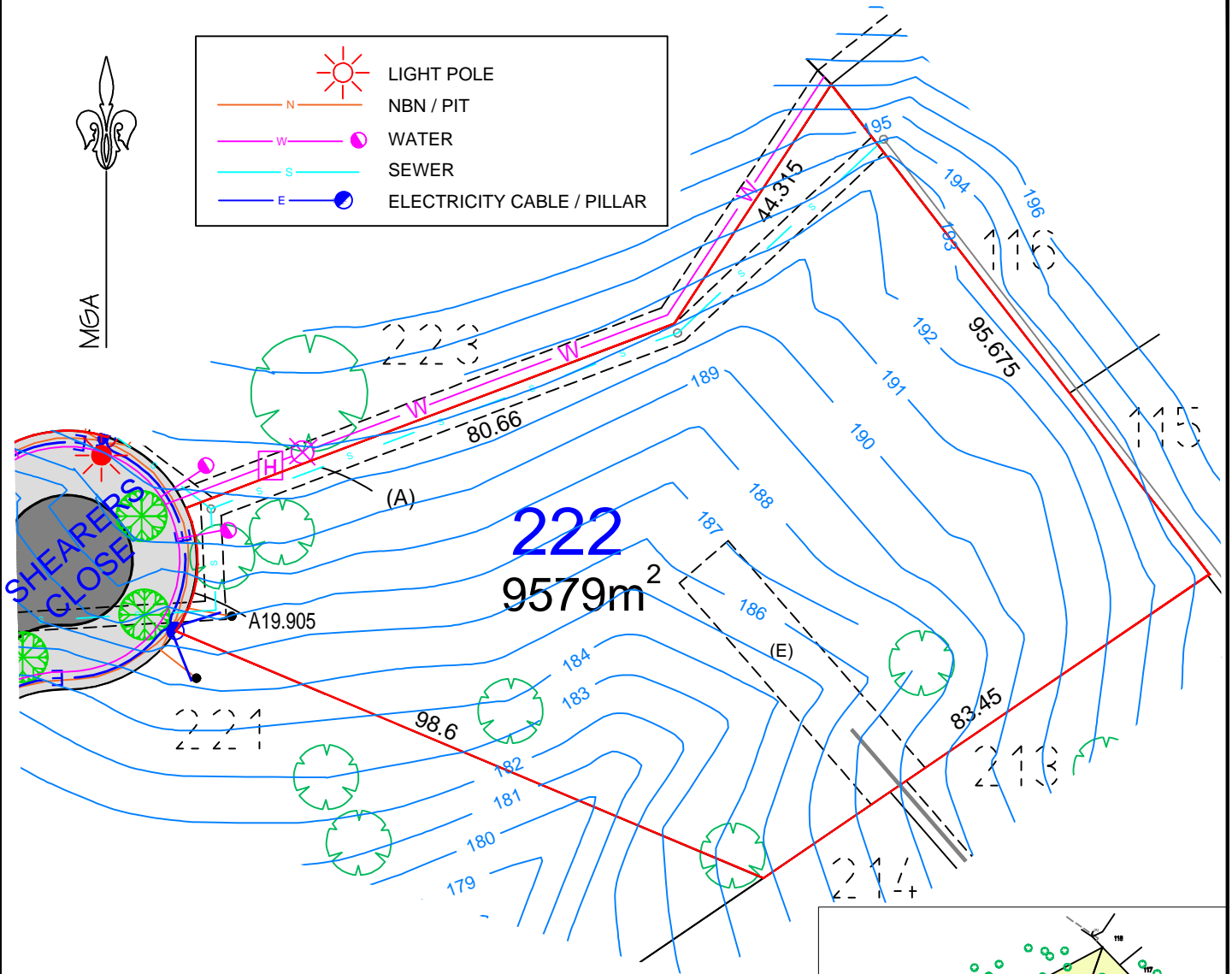

(A) EASEMENT TO DRAIN SEWAGE 3 WIDE AND VARIABLE WIDTH (DP1153819)

(E) EASEMENT TO DRAIN WATER 3 WIDE AND 10 WIDE

DISCLAIMER/NOTES:

1. Contours are based on finished design levels and are subject to construction and Council certification and therefore should not be considered as final or as-built.
2. Location of utility services including but not limited to power, water, sewer, communications and gas are subject to construction and Supply Authority certification and therefore should not be considered as final or as-built.
3. Survey information such as boundary dimensions and areas, easements etc are subject to final survey. Purchasers should refer to the Deposited Plan and 88B Instrument contained in the Contract for Sale of Land for further detailed information.
4. Bushfire and Geotechnical classification are provided for convenience. Purchasers should refer to referenced detail specialists reports.
5. This Preliminary Site Analysis Plan has been collated from various sources of design information and is provided for convenience to assist Purchasers in obtaining quotations/tenders for dwelling construction.
6. This document does not form part of the Contract of Sale of the Land.

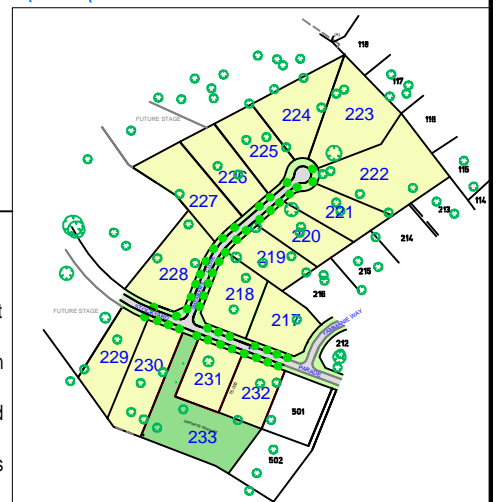

STAGE 2B

MM HYNDES BAILEY & Co.
 REGISTERED SURVEYORS - TOWN PLANNING - CIVIL DESIGN
Surveying the Hunter since 1920



IRONBARK RIDGE - STAGE 2B

LOT 231

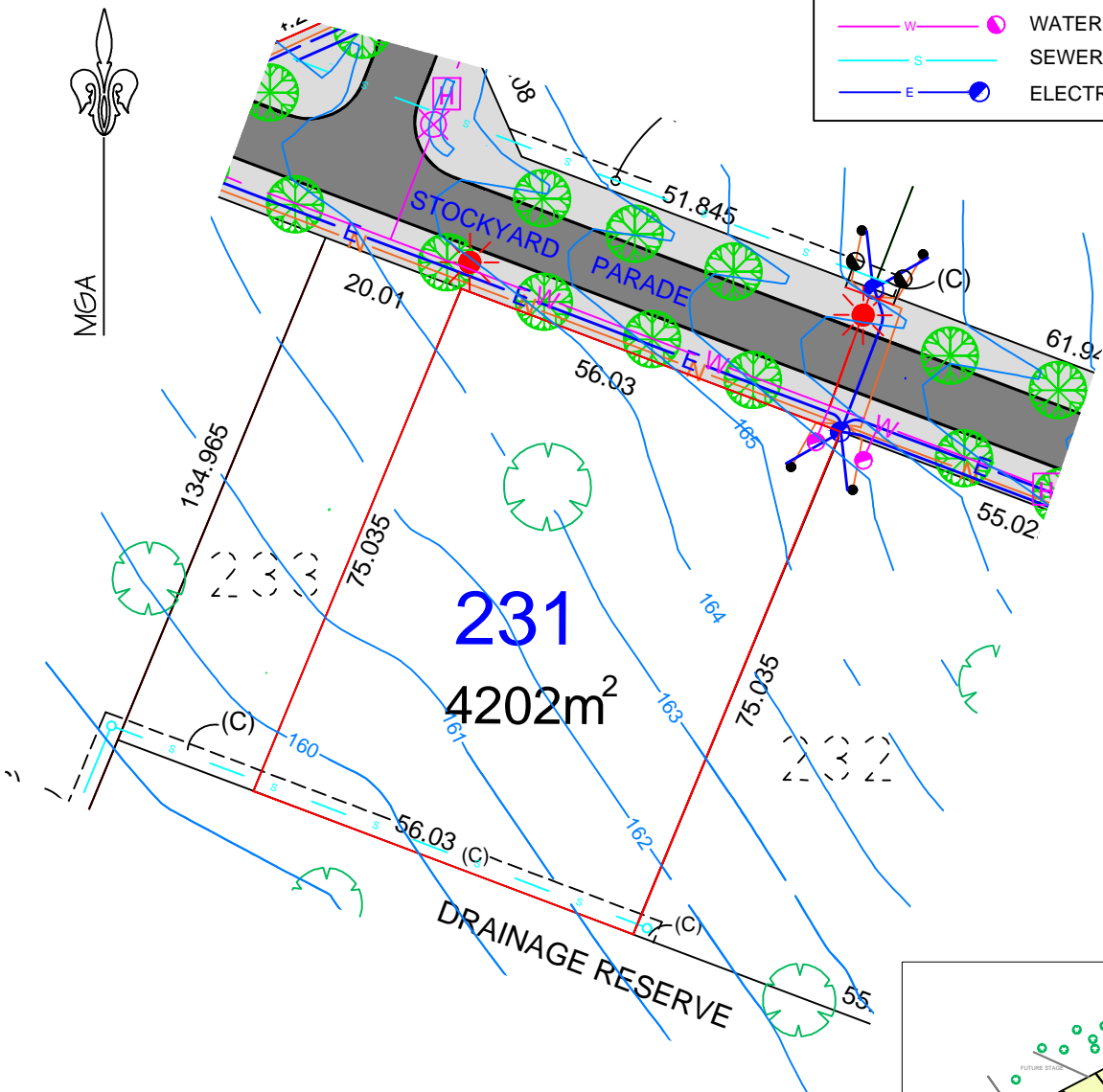
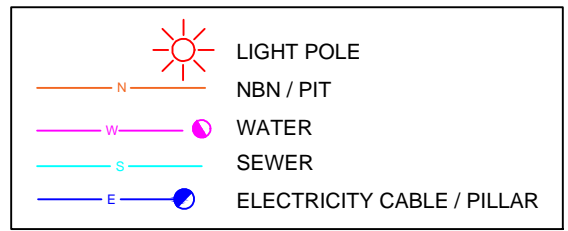

(C) EASEMENT TO DRAIN SEWAGE 3 WIDE AND VARIABLE WIDTH

DISCLAIMER/NOTES:

1. Contours are based on finished design levels and are subject to construction and Council certification and therefore should not be considered as final or as-built.
2. Location of utility services including but not limited to power, water, sewer, communications and gas are subject to construction and Supply Authority certification and therefore should not be considered as final or as-built.
3. Survey information such as boundary dimensions and areas, easements etc are subject to final survey. Purchasers should refer to the Deposited Plan and 88B Instrument contained in the Contract for Sale of Land for further detailed information.
4. Bushfire and Geotechnical classification are provided for convenience. Purchasers should refer to referenced detail specialists reports.
5. This Preliminary Site Analysis Plan has been collated from various sources of design information and is provided for convenience to assist Purchasers in obtaining quotations/tenders for dwelling construction.
6. This document does not form part of the Contract of Sale of the Land.

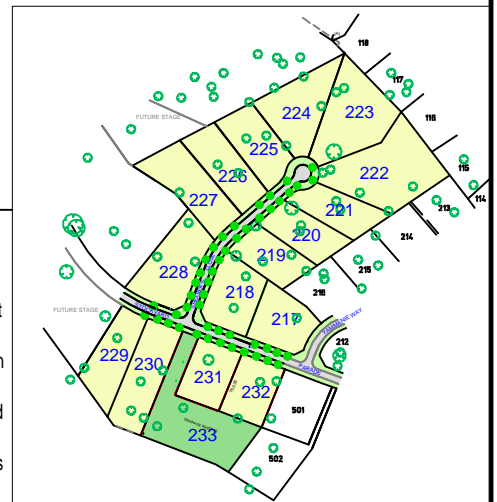

STAGE 2B

MM HYNDES BAILEY & Co.
 REGISTERED SURVEYORS - TOWN PLANNING - CIVIL DESIGN
Surveying the Hunter since 1920



IRONBARK RIDGE — STAGE 2B

LOT 232

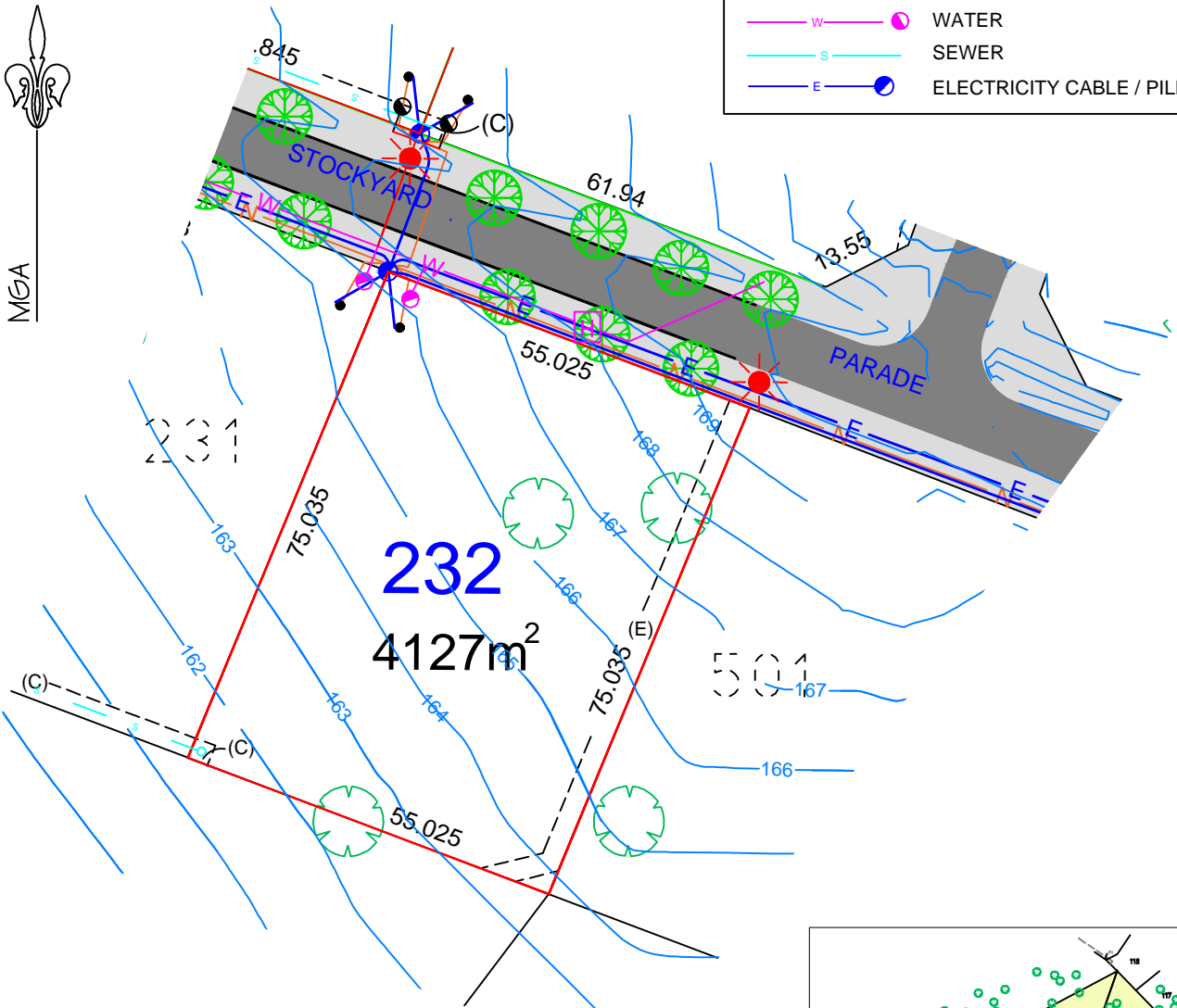
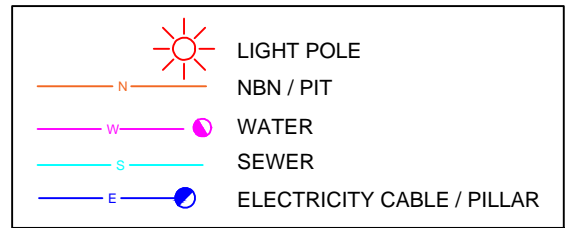

(C) EASEMENT TO DRAIN SEWAGE 3 WIDE AND VARIABLE WIDTH

DISCLAIMER/NOTES:

1. Contours are based on finished design levels and are subject to construction and Council certification and therefore should not be considered as final or as-built.
2. Location of utility services including but not limited to power, water, sewer, communications and gas are subject to construction and Supply Authority certification and therefore should not be considered as final or as-built.
3. Survey information such as boundary dimensions and areas, easements etc are subject to final survey. Purchasers should refer to the Deposited Plan and 88B Instrument contained in the Contract for Sale of Land for further detailed information.
4. Bushfire and Geotechnical classification are provided for convenience. Purchasers should refer to referenced detail specialists reports.
5. This Preliminary Site Analysis Plan has been collated from various sources of design information and is provided for convenience to assist Purchasers in obtaining quotations/tenders for dwelling construction.
6. This document does not form part of the Contract of Sale of the Land.

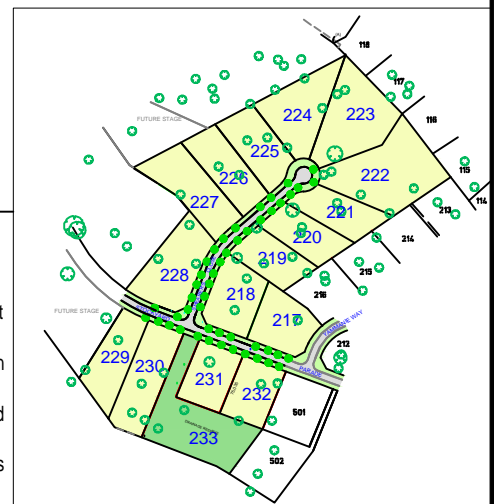

STAGE 2B

MM HYNDES BAILEY & Co.
 REGISTERED SURVEYORS - TOWN PLANNING - CIVIL DESIGN
Surveying the Hunter since 1920

